

O17

Dual pressure controllers



Applications

O17 instruments are dual mechanical pressure switches for high and low pressure, and are equipped with a unipolar SPDT switch that closes and opens as the pressure increases or decreases.

Common features

SPDT single pole switch electrical rating: (except in the case of the dual signal version)	16 (16) A 250V~ normally open or normally closed 1 (1) A 250V~ opposite side.
Ambient operating / storage temperature:	-30°C...+55°C / -40°C...+65°C
Connection to pressure line:	7/16 - 20 UNF straight male output connector, 1/4 flared female connector
Cable entry:	14mm insulating bushing
Refrigerant:	Equipment suitable for use with the most common gases
Installation:	two threaded holes in the back of the casing to accept M4x6mm screws (supplied)
Regulation:	by means of crosshead recessed hex nut for both the set and the differential An adjustable knob is also available, as standard with certain models.
Standard O17 terminals:	1 common, 2 opens when low pressure increases and opens when high pressure increases.
Dual signal O17 terminals:	1 common, 2 closes signal circuit when low pressure decreases, 3 closes signal circuit when high pressure increases, 4 closes when low pressure increases and opens when high pressure increases.
O17 version with dual signal:	terminals 1 and 4 as above, terminals (1 and 2) and (1 and 3): 0,1A 250V~

O17 pressure

16 (16) A 250V~ normally open or normally closed
1 (1) A 250V~ opposite side.
-30°C...+55°C / -40°C...+65°C
7/16 - 20 UNF straight male output connector, 1/4 flared female connector
14mm insulating bushing
Equipment suitable for use with the most common gases
two threaded holes in the back of the casing to accept M4x6mm screws (supplied)
by means of crosshead recessed hex nut for both the set and the differential An adjustable knob is also available, as standard with certain models.
1 common, 2 opens when low pressure increases and opens when high pressure increases.
1 common, 2 closes signal circuit when low pressure decreases, 3 closes signal circuit when high pressure increases, 4 closes when low pressure increases and opens when high pressure increases.
terminals 1 and 4 as above, terminals (1 and 2) and (1 and 3): 0,1A 250V~

Operating and safety pressures

Bellows type	Maximum stationary pressure (bar)	Burst Pressure (bar)
Low Pressure	20	80
High Pressure	35	128
TÜV	35	80 (safety)

Part number	Reset		Measurement range PSI (bar)		Differential PSI (bar)		Type of bellows	Connection
	High	Low	High	Low	High	Low		
O17-H4701	automatic	automatic	100...435 (7...30)	10"...100 (-0.3...7)	50 (3.5)	9...58 (0.6...4)	standard	7/16" - 20 UNF male
O17-H4702	automatic	automatic	100...435 (7...30)	10"...100 (-0.3...7)	50 (3.5)	9...58 (0.6...4)	standard	braze welded tube Ø 6 mm L.100 mm
O17-H6701 °	automatic	automatic	100...435 (7...30)	10"...100 (-0.3...7)	50 (3.5)	9...58 (0.6...4)	standard	7/16" - 20 UNF male
O17-H4703	manual	manual	100...435 (7...30)	10"...100 (-0.3...7)	50 (3.5)	9 (0.6)	standard	7/16" - 20 UNF male
O17-H4704	manual	manual	100...435 (7...30)	10"...100 (-0.3...7)	50 (3.5)	9 (0.6)	standard	braze welded tube Ø 6 mm L.100 mm
O17-H4713	manual	manual	100...435 (7...30)	10"...100 (-0.3...7)	50 (3.5)	9 (0.6)	standard	1000 mm capillary with 1/4" SAE nut
O17-H4705	manual	automatic	100...435 (7...30)	10"...100 (-0.3...7)	50 (3.5)	9...58 (0.6...4)	standard	7/16" - 20 UNF male
O17-H4706	manual	automatic	100...435 (7...30)	10"...100 (-0.3...7)	50 (3.5)	9...58 (0.6...4)	standard	braze welded tube Ø 6 mm L.100 mm
O17-H4715	manual	automatic	100...435 (7...30)	10"...100 (-0.3...7)	50 (3.5)	9...58 (0.6...4)	standard	1000 mm capillary with 1/4" SAE nut
O17-H6705	manual	automatic	100...435 (7...30)	10"...100 (-0.3...7)	50 (3.5)	9...58 (0.6...4)	standard	7/16" - 20 UNF male
O17-H4758	automatic	automatic	100...435 (7...30)	10"...100 (-0.3...7)	58 (4)	9...58 (0.6...4)	TÜV	7/16" - 20 UNF male
O17-H4763	automatic	automatic	100...435 (7...30)	10"...100 (-0.3...7)	58 (4)	9...58 (0.6...4)	TÜV	braze welded tube Ø 6 mm L.100 mm
O17-H4759	manual*	automatic	100...435 (7...30)	10"...100 (-0.3...7)	58 (4)	9...58 (0.6...4)	TÜV	7/16" - 20 UNF male
O17-H4760	manual**	automatic	100...435 (7...30)	10"...100 (-0.3...7)	58 (4)	9...58 (0.6...4)	TÜV	7/16" - 20 UNF male
O17-H4764	manual	automatic	100...435 (7...30)	10"...100 (-0.3...7)	58 (4)	9...58 (0.6...4)	TÜV	braze welded tube Ø 6 mm L.100 mm
O17-H6759 °	manual	automatic	100...435 (7...30)	10"...100 (-0.3...7)	58 (4)	9...58 (0.6...4)	TÜV	7/16" - 20 UNF male
O17-H6764 °	manual	automatic	100...435 (7...30)	10"...100 (-0.3...7)	58 (4)	9...58 (0.6...4)	TÜV	braze welded tube Ø 6 mm L.100 mm
O17-H6703 °	manual	manual	100...435 (7...30)	10"...100 (-0.3...7)	50 (3.5)	9 (0.6)	standard	7/16" - 20 UNF male

° Switch: SINGLE SIGNAL

* reset without removing cover

** reset with removal of cover

Dimensions

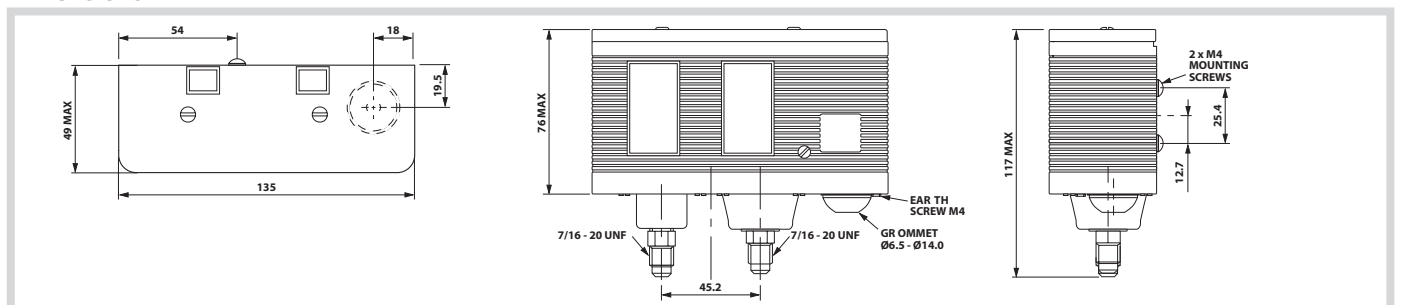

Accessories for O series controllers

Accessories for O series controllers

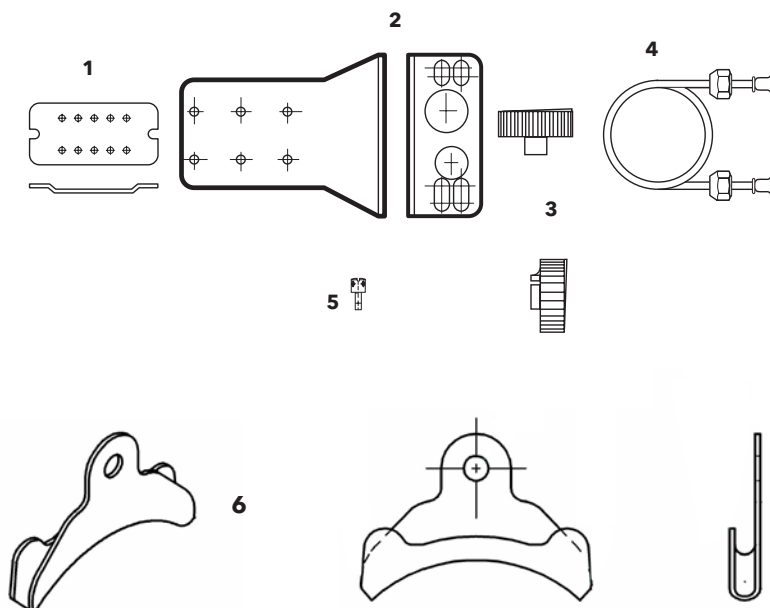

Part number	Description	Notes
00048129003 (1)	Flat mounting bracket	-
00031696001 (2)	Angle mounting bracket	-
03200115001 (3)	Knob	-
06309138001 (4)	1000 mm capillary with 7/16" fittings, without valve opener	-
06309138002 (4)	1500 mm capillary with 7/16" fittings, without valve opener	-
00450199004 (5)	Screw with clearance hole	-
06223029001 (6)	clip for temperature capillary	only O16 temperature
06223029006 (6)	clip for temperature capillary- KIT 6pcs	only O16 temperature